

VEDAFEU C[®] ROPES

**TESTED SMOKE TIGHTNESS
 WITHOUT MECHANICAL FIXING**

“ *The most extensive
 range in firestop systems* ”



FIRESTOP 4H
 EI 240

MOVEMENTS
 +20%

JOINT WIDTHS
 10 to 120mm

**TESTED
 CERTIFIED**

VEDAFEU C[®] ROPE STRENGTHS

CONFIGURATIONS

Tested and certified for horizontal and vertical applications.

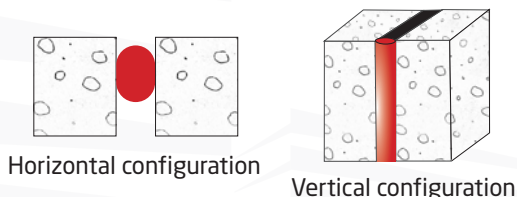

EXPOSURE

Tested and certified not exposed or exposed to fire.

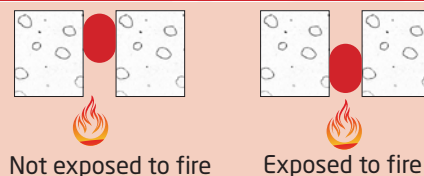

COMPRESSIBILITY

Tested and certified up to **-85%** compression.

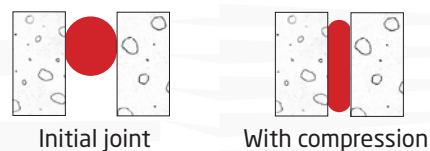

EXPANSION MOVEMENTS

Tested and certified up to **+20%** expansion.

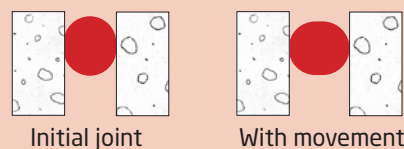

EASY to handle and to install.



SAFE for the health and the environment.



APPLICATIONS

Hospitals, industrial buildings, offices, housing, hotels, malls, car parks, schools, train stations, airports, stadiums, etc.



OFFICIAL CLASSIFICATION

Classification report n° EFR 20-002698 dated 01/09/2020

EI 240 - H - M20 - B - W 10 to 120

EI 240 - V - M20 - B - W 10 to 120

Other classification reports upon request: with sealant, joint cover, EPDM membrane, head-of-wall, exposed to fire...

Refer to classification report or ETA for types and thicknesses of supports validated.



European Technical Assessment: ETA 22/0321.
Declaration of performance: N° C-22/0321

VEDAFEU C[®] Ropes according to initial joint width

| Initial joint width [mm] | 10 | 13 | 20 | 26 | 33 | 40 | 50 | 60 | 70 | 80 | 90 | 100 | 110 | 120 |
|---|----------|-----|-----|-----|-----|-----|-----|-----|--------------------------|------|------|------|------|------|
| Reference* VEDAFEU C [®] Ø rope [mm] | C12 | C20 | C30 | C40 | C50 | C60 | C75 | C90 | C105 | C120 | C135 | C150 | C165 | C180 |
| Quantity [m] | 50 | 30 | | 25 | | 20 | 18 | 10 | Bags of 2 lengths of 2m. | | | | | |
| Conditioning | Per roll | | | | | | | | | | | | | |

*Minimum compression of 33% (except for 10mm gaps : 17%).

Maximum validated gap = initial gap + M20 (20%).

A colour system has been thought to easily identify different diameters and prevent misuse.

Installation instructions for joint widths from 10 to 120mm*



If necessary, remove formwork material such as polystyrene, honeycomb cardboard, etc. Remove dust, using a brush or a broom.



Apply a layer of VEDACOLLE[®]** adhesive with a brush on both sides of the joint.



While the adhesive is still wet, insert VEDAFEU C[®] by hands into the joint.



Splicing of 2 lengths (patented).



VEDAFEU C[®] with junction.

*Brief installation instructions. Complete installation method available upon request.

**When applying the VEDACOLLE[®] adhesive, supports must be dry and clean.

In case of potential exposure to water and/or weather conditions, the system must be protected by a VED'EPDM[®] membrane. For installation accessories, approved concrete supports and thicknesses, please refer to the concerned classification report. The quantities needed for the VEDAFEU installation are indicated in the classification report and in our installation method. Installation video and method available upon request.



CERTIFIED CONFIGURATIONS

CERTIFIED

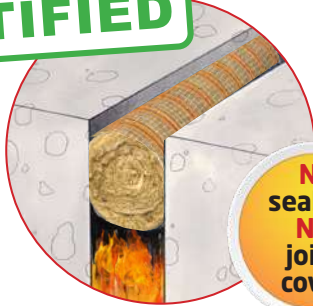

**NO sealant
NO joint cover**

CERTIFIED



**WITH joint cover
NO sealant**

CERTIFIED

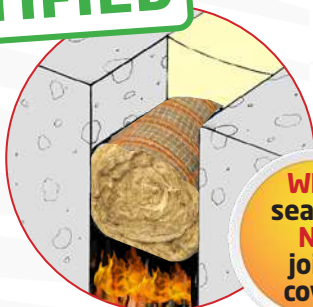

**WITH sealant
NO joint cover**

CERTIFIED

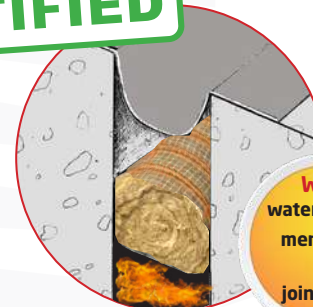

**WITH waterproofing membrane
NO joint cover**

EXAMPLES OF APPLICATIONS

1 Floor, wall and ceiling expansion joints



Application on floor and wall with junctions.



2 Head-of-wall

The use of a single Firestop VEDAFEU C[®] rope at the centre of the joint in a head-of-wall configuration has been tested and certified by Efectis France, CSTB and CERIB.

The last configuration validated offer a performance whatever the fire side with a single Firestop VEDAFEU C[®] rope with a compression rate of 33% in the middle of the masonry without adhesive. Other results are available on page 18.

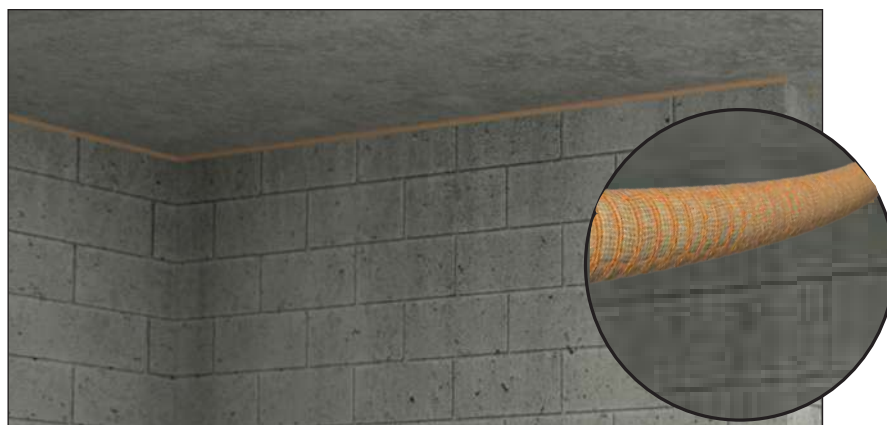

VEDAFEU C[®] in head-of-wall.

| | |
|---------------------------|----------------------------|
| Performance | EI 180 |
| Compression* | 33% |
| Adhesive | No |
| Fire side | Any |
| Rope configuration | At the centre of the joint |
| Masonry support thickness | ≥ 150mm |
| Density of the supports | ≥ 500kg/m ³ |

EASY AND FAST INSTALLATION

- ▶ Can be done even if the access is only possible on one side of the wall.
- ▶ Without adhesive application. Simplified connections.
- ▶ The diameter of rope can be adapted in case of irregular joints.
- ▶ Easy quality control, visual check thanks to our colour code.

Classification report n° EFR-22-003520 A* **EI 180 - T - X - F - W 10 to 80**

*Minimum compression of 33% (except for 10mm gaps : 17%).

*Valid until 24/02/2028

The connections between ropes are made with VEDAFEU SFR sealant.

Adhesive and connection pieces are required for other configurations : rope location, different thicknesses and densities supports. Contact us.

VEDAFEU C[®] ropes - Color code and conditioning

| Joint width (mm) | 10 | 13 | 20 | 26 | 33 | 40 | 50 | 60 | 70 | 80 | 90 | 100 | 110 | 120 |
|---|----------|-----|-----|-----|-----|-----|-----|-----|--------------------------|------|------|------|------|------|
| Reference VEDAFEU C [®] color code and Ø rope (mm) | C12 | C20 | C30 | C40 | C50 | C60 | C75 | C90 | C105 | C120 | C135 | C150 | C165 | C180 |
| Quantity (lm) | 50 | 30 | | 25 | | 20 | 18 | 10 | Bags of 2 lengths of 2m. | | | | | |
| Conditioning | Per roll | | | | | | | | | | | | | |





CERTIFIED INSTALLATION WITH JOINT COVER (Optional)



VEDAFEU C® with special head-of-wall joint cover.

OTHER CERTIFIED CONFIGURATIONS FIRE EXPECTED FROM ONE SIDE

One rope on the opposite side



| | |
|---------------|---------------|
| Performance | EI 240 |
| Compression | 33% |
| Adhesive | Compulsory |
| Accessibility | Opposite side |

Two ropes on the exposed side



| | |
|---------------|---------------|
| Performance | EI 120 |
| Compression | 33% |
| Adhesive | Compulsory |
| Accessibility | Exposed side |

FIRE EXPECTED FROM BOTH SIDES

One rope on each side



| | |
|---------------|---------------|
| Performance | EI 240 |
| Compression | 33% |
| Adhesive | Compulsory |
| Accessibility | Both sides |

Two ropes on one side



| | |
|---------------|---------------|
| Performance | EI 120 |
| Compression | 33% |
| Adhesive | Compulsory |
| Accessibility | Any sides |



Other applications

Windows and doors frames, bearing protection, facade panels, tunnels ...



VEDAFEU C[®] PROPERTIES

VEDAFEU C[®] firestop rope COMPRESSIBILITY tests

| Ref. | Test | Load F (kN) and VEDAFEU C [®] | Compressibility | Immediate form recovery | After 2 hours form recovery | After 72 hours form recovery |
|---------------------------------|---------|--|-----------------|-------------------------|-----------------------------|------------------------------|
| VEDAFEU C [®] Ø 60 | 1 | 11,5 | 83% | 57% | 63% | 73% |
| | 2 | 12,1 | 83% | 57% | 63% | 70% |
| | 3 | 11,5 | 83% | 60% | 65% | 73% |
| | AVERAGE | | | 83% | 58% | 64% |
| VEDAFEU C [®] Ø 100 | 1 | 30,3 | 86% | 52% | 63% | 72% |
| | 2 | 30,3 | 86% | 61% | 72% | 83% |
| | 3 | 30,3 | 86% | 57% | 72% | 81% |
| | AVERAGE | | | 86% | 57% | 69% |
| VEDAFEU C [®] Ø 150 | 1 | 100 | 86% | 40% | 69% | 74% |
| | 2 | 100 | 87% | 44% | 60% | 63% |
| | 3 | 100 | 88% | 46% | 60% | 64% |
| | AVERAGE | | | 87% | 43% | 63% |



Results of test report n° MRF 19 26080307 dated 14/05/2019 (available upon request).

VEDAFEU C[®] firestop rope SHEARING tests

| Reference VEDAFEU C [®] | VEDAFEU C60 | VEDAFEU C100 | VEDAFEU C150 |
|----------------------------------|-------------|--------------|--------------|
| Maximum load - Fmax (daN) | 76,2 | 60,7 | 215,2 |
| Displacement at Fmax (mm) | 55,1 | 43,6 | 40,4 |



Results of test report n° EEM 20 26087588 dated 26/10/2020 (available upon request).

VEDAFEU C[®] AIR and SMOKE tightness

| Nominal pressure (Pa) | 50 | 100 | 150 | 200 | 250 |
|-----------------------|-----|-----|-----|-----|-----|
| Permeability (m³/h) | 0.0 | 0.0 | 0.0 | 0.0 | 0.0 |



Results of test report n° 16-26061937 dated 22/03/2016 (available upon request).

VEDAFEU C[®] THERMAL Properties In accordance with the Thermal Regulation RT 2012

| Thermal resistance | C30 | C50 | C60 | C70 | C90 | C120 | C180 | Ø mm | ASTM D5930 |
|--------------------|------|------|------|------|------|------|------|--------|------------|
| | 0,70 | 1,23 | 1,84 | 1,77 | 2,47 | 3,46 | 5,55 | m².K/W | |



The thermal value (λ) of VEDAFEU C[®] firestop rope is about 0.040 W/mK at 20°C.

Results of test report n° RA.15.36.EB-V3a dated 29/06/2016 (available upon request).

VEDAFEU C[®] ACOUSTIC Properties In accordance with the NRA (acoustic regulations)

| Sound attenuation | C30 | C60 | C90 | C120 | C150 | C180 | Ø mm | EN ISO 717 - 1 |
|-------------------|-----|-----|-----|------|------|------|------|----------------|
| | 34 | 36 | 40 | 40 | 40 | 40 | dB | |



Sound attenuation (dB) depending on diameter of rope (mm).

Results of test report n° BEB2.F.6023 dated 09/07/2015 (available upon request).

