

Joint de dilatation de sol tout métal pour extérieur et intérieur permettant les mouvements de dilatation et de contraction ainsi que les mouvements verticaux et de cisaillement. Pour tous types de finitions : dalle, chape, carrelage, marbre...



All metal floor expansion joint for exterior and interior use, allowing expansion and contraction of the joint as well as vertical movement and unlimited shear movement. For all types of finishes: screed, natural stone, cast stone, marble...



JDH 6.12

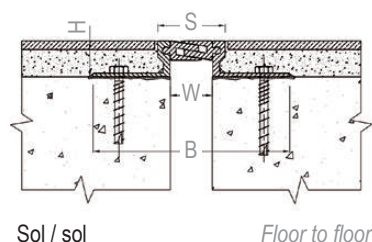

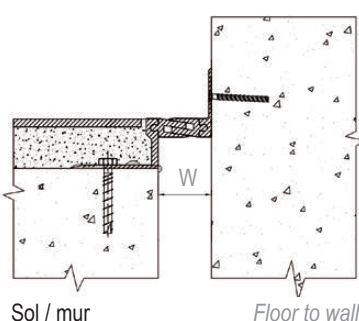

JDH 6.12 A avec cornière apparente  
 With visible side plate

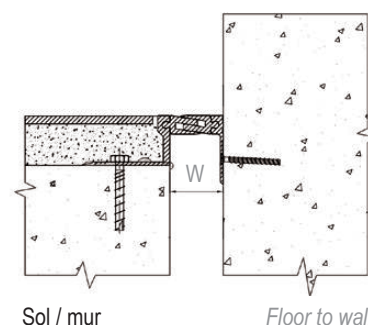

JDH 6.12 A avec cornière invisible  
 With invisible side plate



Ref. JDH 6.12	6.12-040	6.12-060	6.12-110
W [mm] Ouverture jusqu'à / Gap up to	40	60	110
H [mm] Hauteur / Depth	20 / 35 / 50 / 80 / 100		
S [mm] approx.	65	90	135
B [mm] approx.	190	215	260
Mouvements admissibles [mm] <i>Movement capacities [mm]</i>	+8 / -8	+15 / -15	+25 / -25
Matériau / Material	Aluminium / Aluminium		
Longueur standard [m] / Standard length [m]	3		
Charges [kN] <i>Load-bearing capacities [kN]</i>	 		

Pièces spéciales L, T et X sur demande. / Special pieces L, T and X upon request.

Assemblage des profilés avec pattes de montage sur demande. / Assembled profiles with spacing leg upon request.

Fixations : nous consulter pour préconisation. / Fixings: please contact us for technical recommendation.

Veuillez nous consulter pour vérifier l'utilisation du produit avec des engins à roues non pneumatiques. / Please contact us in case of traffic of vehicles with non-pneumatic wheels.

The load-bearing capacity is always indicated for a joint in its initial position. In case of opening movements, the load-bearing capacity significantly reduces and the product will thus be only adapted for a light pedestrian traffic. The indicated load-bearing capacities are based on pneumatic wheels vehicles with a contact surface of 200x200 mm.

© All rights reserved - Non contractual drawings - 11/2021