



**VEDA FRANCE**

Joints bâtiment - Building joints

# Joint de dilatation de sol tout métal

## All metal floor expansion joint

### Series JDH 6.35

Joint de dilatation de sol tout aluminium pour extérieur et intérieur. Pour tous types de finition : dalle, chape, carrelage, marbre...

Idéal pour des différences de niveaux jusqu'à 40 mm.

*Aluminium floor expansion joint for exterior and interior use.*

*For all types of finishes : screed, natural stone, cast stone, marble...*

*Recommended in case of vertical differences up to 40mm.*



**JDH 6.35-050 à / to 150**

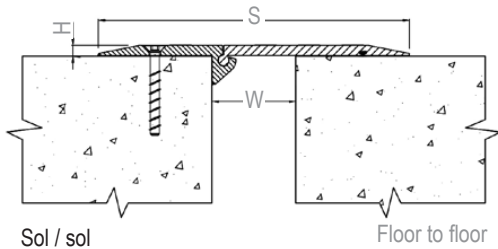

**JDH 6.35-200 à / to 300**

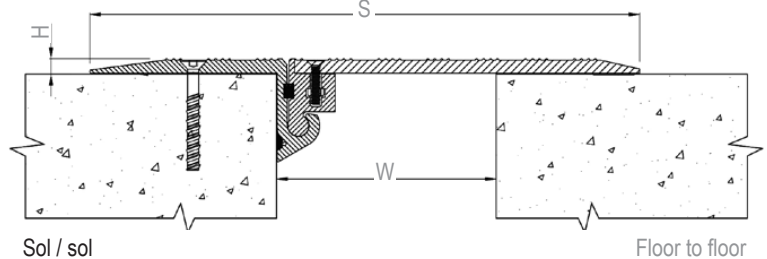

**JDH 6.35-200 à / to 300**  
avec différences de niveaux /  
with vertical differences

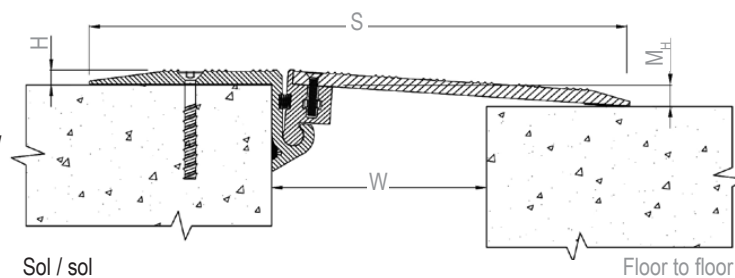

Ref. JDH 6.35	6.35-050	6.35-075	6.35-100	6.35-150	6.35-200	6.35-250	6.35-300
W [mm] Ouverture jusqu'à / Gap up to	50	75	100	150	200	250	300
H [mm] Hauteur* / Depth*	6	9	9	12	13	12	12
S [mm] approx	238	277	302	400	501	601	686
Mouvements admissibles [mm] Movement capacities [mm]	+85 / -30	+75 / -50	+100 / -75	+120 / -120	+145 / -145	+175 / -175	+215 / -215
Mouvements verticaux $M_H$ [mm] Vertical movements $M_H$ [mm]	Jusqu'à 40 / Up to 40						
Matériau / Material	Aluminium / Aluminium						
Longueur standard [m] / Standard length [lm]	3						
Charges Load-bearing capacities							

\*Selon les charges de votre projet les épaisseurs peuvent être ajustées en usine. / Depending on the required load bearing capacity, the thickness of the product can be adjusted in factory. Fixations : nous consulter pour préconisation. / Fixings: please contact us for technical recommendation.

The load-bearing capacity is always indicated for a joint in its initial position. In case of opening movements, the load-bearing capacity significantly reduces and the product will thus be only adapted for a light pedestrian traffic. The indicated load-bearing capacities are based on pneumatic wheels vehicles with a contact surface of 200x200 mm.

© All rights reserved - Non contractual drawings - 03/2022

Certified management system

ISO 9001:2015

**BUREAU VERITAS**  
Certification



**GV2 VEDA FRANCE**

20, Allée des Erables - Bât. E - 93420 Villepinte - France

Postal Address

CS 63052 - 95972 Roissy CDG Cedex

Tel : + 33 (0)1 48 61 70 80

Fax : + 33 (0)1 48 61 70 81

E-mail : contact@vedafrance.com

Web : www.vedafrance.com



**VEDA FRANCE**

Jointes bâtiment - Building joints

# Joint de dilatation de sol tout métal

## All metal floor expansion joint

### Series JDH 6.35 A

Joint de dilatation de sol tout aluminium pour extérieur et intérieur. Pour tous types de finition : dalle, chape, carrelage, marbre...

Idéal pour des différences de niveaux jusqu'à 40 mm.

*Aluminium floor expansion joint for exterior and interior use. For all types of finishes : screed, natural stone, cast stone, marble...*

*Recommended in case of vertical differences up to 40mm.*



#### JDH 6.35-050 A à / to 150 A

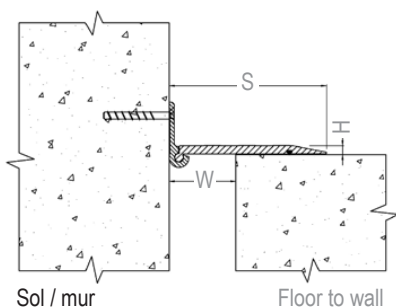

#### JDH 6.35-200 A à / to 300 A

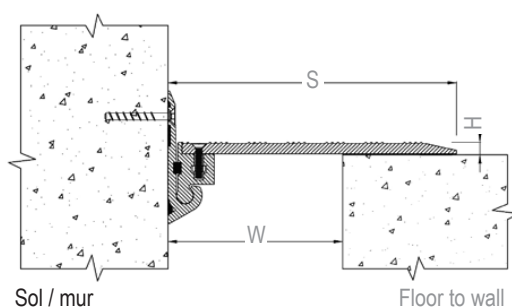

#### JDH 6.35-200 A à / to 300 A

avec différences de niveaux /  
with vertical differences

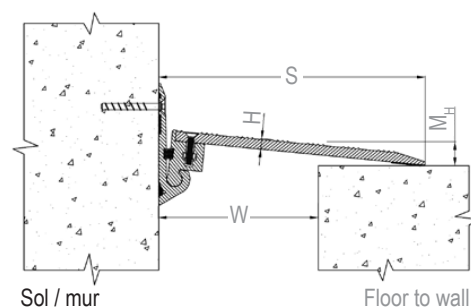

Ref. JDH 6.35 A	6.35-050 A	6.35-075 A	6.35-100 A	6.35-150 A	6.35-200 A	6.35-250 A	6.35-300 A
W [mm] Ouverture jusqu'à / Gap up to	50	75	100	150	200	250	300
H [mm] Hauteur* / Depth*	6	9	9	12	12	12	13
S [mm] approx	137	177	202	286	330	430	515
Mouvements admissibles [mm] Movement capacities [mm]	+65 / -30	+80 / -50	+100 / -75	+100 / -125	+100 / -145	+125 / -175	+150 / -215
Mouvements verticaux $M_H$ [mm] Vertical movements $M_H$ [mm]	Jusqu'à 40 / Up to 40						
Matériau / Material	Aluminium / Aluminium						
Longueur standard [ml] / Standard length [lm]	3						
<b>Charges</b> Load-bearing capacities							

\*Selon les charges de votre projet les épaisseurs peuvent être ajustées en usine. / Depending on the required load bearing capacity, the thickness of the product can be adjusted in factory. Fixations : nous consulter pour préconisation. / Fixings: please contact us for technical recommendation.

The load-bearing capacity is always indicated for a joint in its initial position. In case of opening movements, the load-bearing capacity significantly reduces and the product will thus be only adapted for a light pedestrian traffic. The indicated load-bearing capacities are based on pneumatic wheels vehicles with a contact surface of 200x200 mm.

© All rights reserved - Non contractual drawings - 03/2022

Certified management system

ISO 9001:2015

**BUREAU VERITAS**  
Certification



**GV2 VEDA FRANCE**

20, Allée des Erables - Bât. E - 93420 Villepinte - France

Postal Address

CS 63052 - 95972 Roissy CDG Cedex

Tel : + 33 (0)1 48 61 70 80

Fax : + 33 (0)1 48 61 70 81

E-mail : contact@vedafrance.com

Web : www.vedafrance.com