



**VEDA FRANCE**  
 Joints bâtiment - Building joints

# Joint de dilatation de sol

## Mechanical floor joint

### Series JDH 5.02

Joint de dilatation de sol pour extérieur et intérieur constitué de cornières en aluminium et d'un insert souple interchangeable pour tout type de finition : dalle, chape, carrelage, etc.

*Mechanical floor expansion joint made of aluminium side plates and interchangeable flexible insert for all types of finishes: screed, natural stone, cast stone, etc.*



JDH 5.02-050



Profilé encastré JDH 5.02-050  
 Embedded profile JDH 5.02-050

JDH 5.02-040

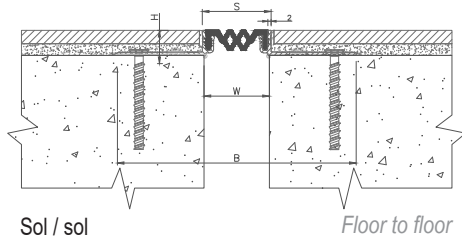

Sol / sol

Floor to floor

JDH 5.02-060 A visible side part

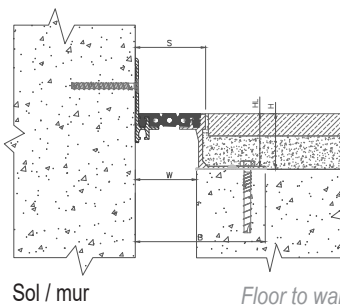

Sol / mur

Floor to wall

JDH 5.02-060 A invisible side part

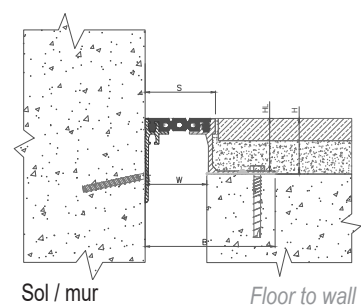

Sol / mur

Floor to wall

Ref. JDH 5.02	5.02-020	5.02-030	5.02-040	5.02-050	5.02-060
<b>W [mm] Ouverture jusqu'à / Gap up to</b>	20	30	40	50	60
<b>H [mm] Hauteur / Height</b>	15   20	15   20	15   20	20   26   35*   40*   50*	20   26   35*   40*   50*
<b>S [mm] approx.</b>	25	35	45	50	60   65
<b>B [mm] approx.</b>	85	95	105	160	170
<b>Mouvements admissibles [mm] Movement capacity [mm]</b>	+3 / -3	+7 / -7	+10 / -10	+7 / -7	+10 / -10
<b>Couleurs de l'insert / Insert colors</b>	Noir, gris** / Black, grey**				
<b>Matériaux / Materials</b>	Aluminium, nitrile / Aluminium, nitrile				
<b>Longueur standard [m] / Standard length [m]</b>	3				
<b>Charges Load-bearing capacity</b>					

\*Capots inox et laiton pour finition luxueuse disponibles / Stainless steel and brass caps for luxury finish available.

\*\*Insert lisse uniquement disponible en 5.02-050 (autres ouvertures nous consulter). / Smooth insert available only on 5.02-050 (other gaps upon request).

Thermosoudures d'insert préconisées pour les raccords. / Hot-welding recommended for junction of the flexible insert.

Vidéo d'installation et fiche de pose disponibles sur demande. / Installation video and installation instruction upon request.

The load-bearing capacity is always indicated for a joint in its initial position.

© All rights reserved - Non contractual drawings - 10/2023

Certified management system

ISO 9001:2015  
**BUREAU VERITAS**  
 Certification



**GV2 VEDA FRANCE**

20, Allée des Erables - Bât. E - 93420 Villepinte - France

**Postal Address**

CS 63052 - 95972 Roissy CDG Cedex

**Tel** : + 33 (0)1 48 61 70 80

**Fax** : + 33 (0)1 48 61 70 81

**E-mail** : export@vedafrance.com

**Web** : www.vedafrance.com