



Joint de dilatation pour faux plafonds

Suspended ceiling expansion joint

Series JDV 4.16

Joint de dilatation métal sismique pour faux plafonds constitué de cornières en aluminium et d'un insert souple interchangeable. Pour gares, aéroports, centres commerciaux...

Metal seismic expansion joint for suspended ceilings made of aluminium side plates and interchangeable flexible insert. For train stations, airports, shopping centres...

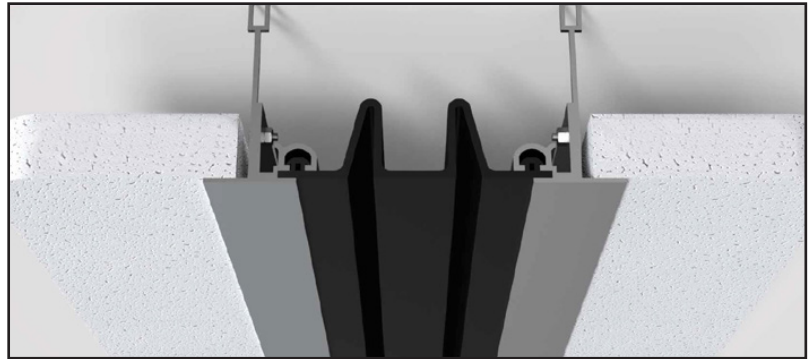

JDV 4.16-050

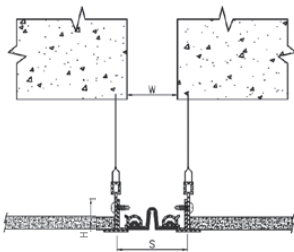

Plat Flat

JDV 4.16-200

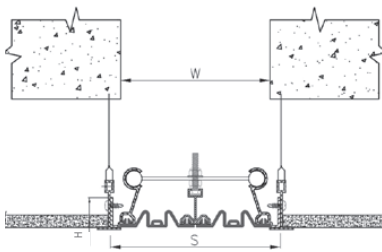

Plat Flat

JDV 4.16-050 A

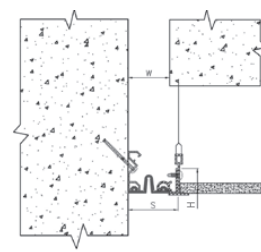

Angle Angle

JDV 4.16-200 A

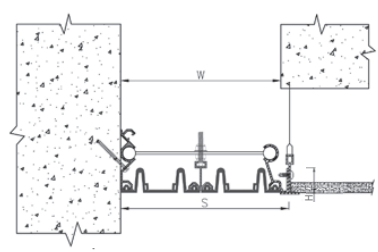

Angle Angle

| Ref. JDV 4.16 | 4.16-050 | 4.16-075 | 4.16-100 | 4.16-125 | 4.16-150 | 4.16-200 | 4.16-250 |
|--|--|---------------|-----------|---------------|-----------|-------------|-------------|
| W [mm] Ouverture jusqu'à / Gap up to | 50 | 75 | 100 | 125 | 150 | 200 | 250 |
| H [mm] Hauteur / Height | 30 | | | | | | |
| S [mm] approx. | 70 | 95 | 120 | 145 | 170 | 220 | 270 |
| Mouvements admissibles [mm] / Movement capacity [mm] | +25 / -25 | +37,5 / -37,5 | +50 / -50 | +62,5 / -62,5 | +75 / -75 | +100 / -100 | +125 / -125 |
| Matériaux / Materials | Aluminium, TPV (thermoplastique vulcanisé) / Aluminium, TPV (vulcanized thermoplastic) | | | | | | |
| Longueur standard [ml] / Standard length [lm] | 3 | | | | | | |

| Ref. JDV 4.16 A | 4.16-050 A | 4.16-075 A | 4.16-100 A | 4.16-125 A | 4.16-150 A | 4.16-200 A | 4.16-250 A |
|--|--|---------------|------------|---------------|------------|-------------|-------------|
| W [mm] Ouverture jusqu'à / Gap up to | 50 | 75 | 100 | 125 | 150 | 200 | 250 |
| H [mm] Hauteur / Height | 30 | | | | | | |
| S [mm] approx. | 60 | 85 | 110 | 135 | 160 | 210 | 260 |
| Mouvements admissibles [mm] / Movement capacity [mm] | +25 / -25 | +37,5 / -37,5 | +50 / -50 | +62,5 / -62,5 | +75 / -75 | +100 / -100 | +125 / -125 |
| Matériaux / Materials | Aluminium, TPV (thermoplastique vulcanisé) / Aluminium, TPV (vulcanized thermoplastic) | | | | | | |
| Longueur standard [ml] / Standard length [lm] | 3 | | | | | | |

Les suspentes ne sont pas fournies avec les profilés. / Hooks are not supplied with the profiles.
Pivot d'autocentrage disponible à partir de l'ouverture 150 mm. / Centering pivot available from gap 150mm.

© All rights reserved - Non contractual drawings - 05/2024

Certified management system



GV2 VEDA FRANCE
20, Allée des Erables - Bât. E - 93420 Villepinte - France
Postal Address
CS 63052 - 95972 Roissy CDG Cedex

Tel : + 33 (0)1 48 61 70 80
Fax : + 33 (0)1 48 61 70 81
E-mail : export@vedafrance.com
Web : www.vedafrance.com